

SX

POMPE SOMMERSE 4", 6", 8", 10"
 4", 6", 8", 10" SUBMERSIBLE BOREHOLE PUMPS
 POMPES IMMERGEES 4", 6", 8", 10"
 HYDRAULIKY 8", 10"

50 Hz
 n ≈ 2900 rpm

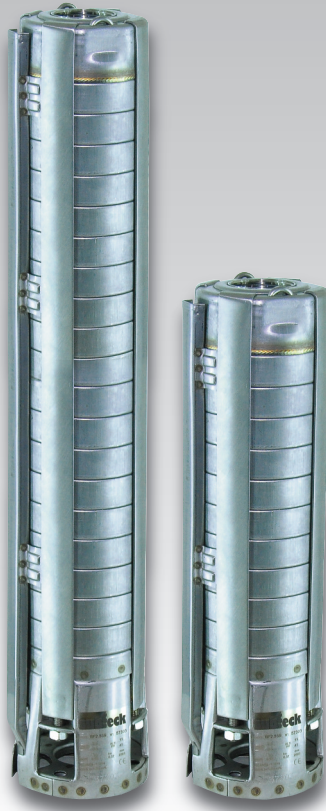

Pompe per applicazioni specifiche ad alto contenuto di sabbia. - Pumps for specific applications with high percentage of solids and sand
 Pompes pour applications spécifiques à haute teneur en solides et sable. - Hydrauliky pro specifické aplikace s vysokým podílem pevných látek a písku

Campo di applicazione - Coverage chart - Graphique d'utilisation - Výkonový graf

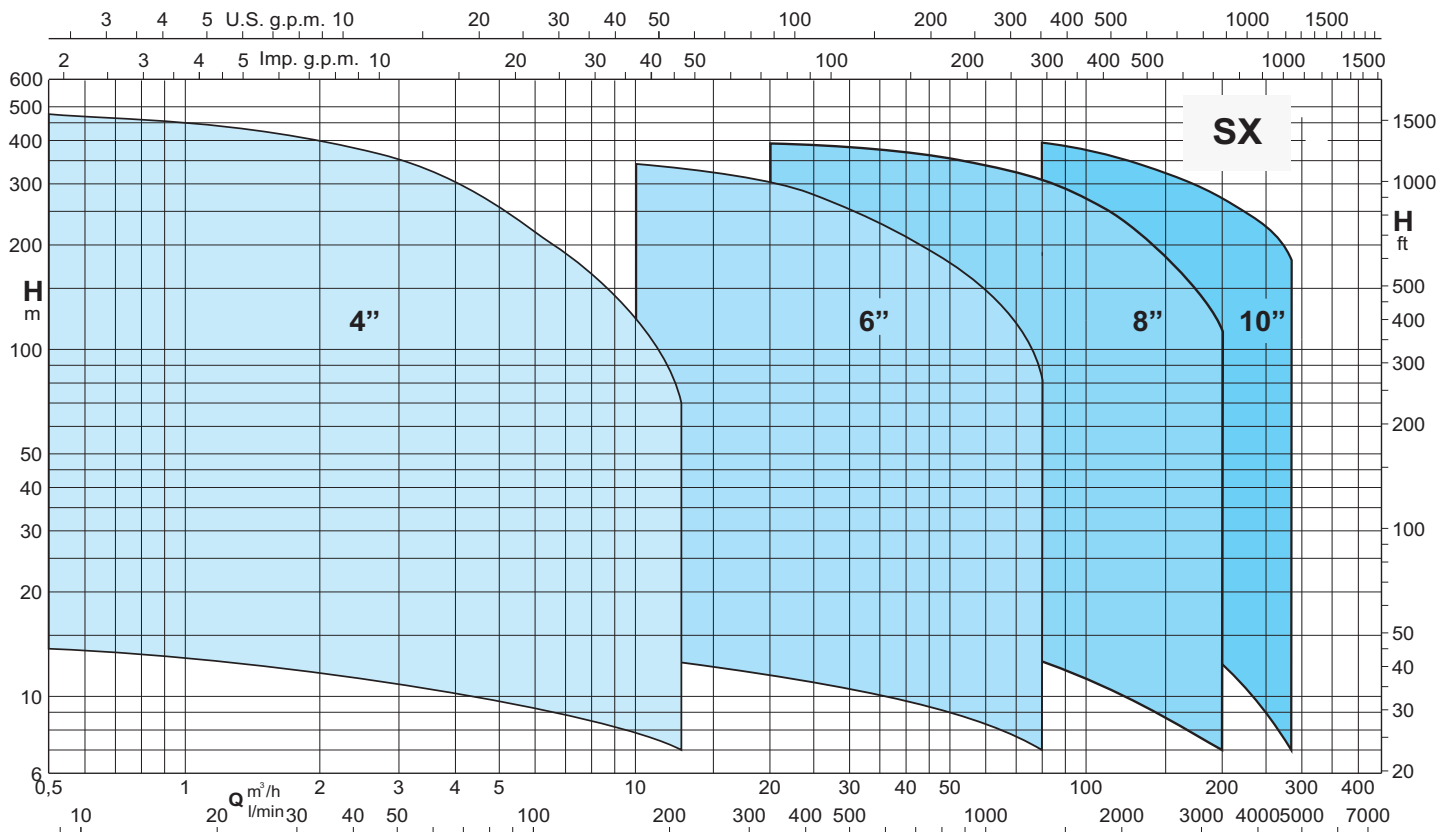

Tolleranze secondo ISO 9906-A - Tolerances according to ISO 9906-A - Tolérances suivant ISO 9906-A - Tolerancias según ISO 9906-A
 Le curve di prestazione sono basate su valori di viscosità cinematica = 1 mm²/s e densità pari a 1000 kg/m³ - Les courbes de performances sont basées sur des valeurs de viscosité cinématique égale à 1 mm²/s et une densité égale à 1000 kg/m³ The performance curves are based on the kinematic viscosity values = 1 mm²/s and density equal to 1000 kg/m³ - Výkonové křivky jsou vztaženy k hodnotám kinematické viskozity = 1 mm² / sa hustotě rovné 1000 kg / m³

SX

POMPE SOMMERSE 4", 6", 8", 10"
4", 6", 8", 10" SUBMERSIBLE BOREHOLE PUMPS
POMPES IMMERGEES 4", 6", 8", 10"
HYDRAULIKY 8", 10"

subteck**Esecuzione**

Elettropompe sommerse di acciaio inossidabile al nichel-cromo per pozzi profondi da 4,6,8,10".

SX: con camicia esterna e stadi in acciaio inossidabile AISI 304.

SX.N: con camicia esterna e stadi in acciaio inossidabile AISI 316.

Giranti: - Radiali: SX4 1,5-2,8-4-5,5-10
 - Semiassiali: SX4 13-20, SX6- SX8 - SX10

Bocca: Filettata ISO 228

Valvola di ritegno incorporata nel corpo di mandata.

Impieghi

Per l'approvvigionamento d'acqua. Per applicazioni civili e industriali.
 Per impianti antincendio. Per irrigazione.

Limiti d'impiego

Temperatura acqua fino a 30 °C.

Massima quantità di sabbia nell'acqua: 300 g/m³.

Servizio continuo.

Materiali

Componenti	SX	SX/N
Camicia esterna	Acciaio Cr Ni AISI 304	Acciaio Cr Ni Mo AISI 316L
Lanterna aspirante		
Coperchio superiore	Acciaio Cr Ni	Acciaio Cr Ni Mo
Corpo di mandata	AISI 304	AISI 316L
Filtro	Acciaio Cr Ni	Acciaio Cr Ni Mo
Valvola completa	AISI 304	AISI 316L
O-ring valvola	NBR	
Giunto completo	Acciaio Cr Ni Mo AISI 316	
Diffusore	Acciaio Cr Ni AISI 304	Acciaio Cr Ni Mo AISI 316L
Corpo stadio		
Girante	Acciaio Cr Ni	Acciaio Cr Ni Mo
Albero	AISI 304	AISI 316L
Anello di tenuta	NBR	
Cuscinetto di guida	NBR	
Copricavo, Viteria	Acciaio Cr Ni Mo AISI 316	

Esecuzioni speciali a richiesta

- Altre tensioni. - Frequenza 60 Hz.

**Exécution**

Electropompes immergées en acier inoxydable au chrome-nickel pour puits de 4,6,8,10".

SX: avec chemise extérieure et étages en acier inox AISI 304

SX N: avec chemise extérieure et étages en acier inox AISI 316.

Roues: - Roues radiales: SX4 1,5-2,8-4-5,5-10
 - Roues hélicocentrifuges: SX4 13-20, SX6- SX8 - SX10

Orifice: Orifice fileté ISO 228

Clapet de retenue incorporé dans le corps de refoulement.

Utilisations

Pour eau propres, non agressifs. Pour l'approvisionnement en eau.
 Pour irrigation. Pour applications civiles, industrielles et pour services incendie.

Limites d'utilisations

Température de l'eau jusqu'à 30 °C.

Max quantité de sable dans l'eau: 300 g/m³.

Service continu.

Matériaux

Composants	SX	SX/N
Chemise extérieure	Acier Cr-Ni AISI 304	Acier Cr-Ni-Mo AISI 316L
Lanterne d'aspiration		
Couvercle supérieur	Acier Cr-Ni	Acier Cr-Ni-Mo
Corps de refoulement	AISI 304	AISI 316L
Panier,	Acier Cr-Ni	Acier Cr-Ni-Mo
Clapet, ensemble	AISI 304	AISI 316L
Joint de clapet	NBR	
Accouplement	Acier Cr-Ni-Mo AISI 316	
Diffuseur	Acier Cr-Ni AISI 304	Acier Cr-Ni-Mo AISI 316L
Corps d'étage		
Roue	Acier Cr-Ni	Acier Cr-Ni-Mo
Arbre	AISI 304	AISI 316L
Bague d'étanchéité	NBR	
Coussinet	NBR	
Protège-câble, Vis	Acier Cr-Ni-Mo AISI 316	

Exécutions spéciales sur demande

- Autres tensions. - Fréquence 60 Hz.

Construction

Submersible motor pumps in chrome-nickel stainless steel for deep wells of 4,6,8,10".

SX: with external jacket and stages in stainless steel AISI 304.

SX N: with external jacket and stages in stainless steel AISI 316.

Impellers: - Radial impellers: SX4 1,5-2,8-4-5,5-10
 - Mixed flow impellers: SX4 13-20, SX6- SX8 - SX10

Connection: Screwed connection ISO 228

Delivery casing with built-in non-return valve.

Applications

For clean water, non-aggressive. For water supply. For irrigation.
 For civil and industrial applications. For fire fighting applications.

Operating conditions

Liquid temperature up to a 30 °C.

Max. sand quantity into the water: 300 g/m³.

Continuous duty.

Materials

Components	SX	SX/N
External jacket	Cr-Ni steel AISI 304	Cr-Ni-Mo steel AISI 316L
Suction lantern		
Upper cover	Cr-Ni steel	Cr-Ni-Mo steel
Delivery casing	AISI 304	AISI 316L
Strainer	Cr-Ni steel	Cr-Ni-Mo steel
Valve set	AISI 304	AISI 316L
O-ring valve	NBR	
Coupling set	Cr-Ni-Mo steel AISI 316	
Diffuser	Cr-Ni steel AISI 304	Cr-Ni-Mo steel AISI 316L
Stage casing		
Impeller	Cr-Ni steel	Cr-Ni-Mo steel
Shaft	AISI 304	AISI 316L
Wear ring	NBR	
Bearing bush	NBR	
Cable guard, Screws	Cr-Ni-Mo steel AISI 316	

Speciální vlastnosti na vyžádání

- Jiné napětí - 60 Hz frekvence.

**Konstrukce**

Hydrauliky z chromniklové nerezové oceli pro hluboké vrty 4,6,8,10".

SX: s vnějším pláštěm a články z nerezové oceli AISI 304.

SX N: s vnějším pláštěm a články z nerezové oceli AISI 316.

Oběžná kola: - Radiální: SX4 1,5-2,8-4-5,5-10
 - Smíšené: SX4 13-20, SX6- SX8 - SX10

Connection: Screwed connection ISO 228
 Delivery casing with built-in non-return valve.

Apikace

Připojení: Šroubové připojení ISO 228

Zabudovaný zpětný ventil.

Pracovní podmínky

Teplota kapaliny do 30 °C.

Max. množství písku do vody: 300 g / m³.

Nepřetržitý provoz.

Materiály

Součásti	SX	SX/N
Vnější plášť	Cr-Ni ocel AISI 304	Cr-Ni-Mo ocel AISI 316L
Sací hrdlo		
Horní kryt	Cr-Ni ocel	Cr-Ni-Mo ocel
Výtláčné hrdlo	AISI 304	AISI 316L
Šítko	Cr-Ni ocel	Cr-Ni-Mo ocel
Sada ventilů	AISI 304	AISI 316L
Kroužek ventilu	NBR	
Spojovací sada	Cr-Ni-Mo ocel AISI 316	
Difuzor	Cr-Ni ocel AISI 304	Cr-Ni-Mo ocel AISI 316L
Těleso hydrauliky		
Oběžné kolo	Cr-Ni ocel	Cr-Ni-Mo ocel
Hřídel	AISI 304	AISI 316L
Pojistný kroužek	NBR	
Ložiskové pouzdro	NBR	
Kryt kabelu, šrouby	Cr-Ni-Mo ocel AISI 316	

Speciální vlastnosti na vyžádání

- Jiné napětí - frekvence 60 Hz.

SX10 280

POMPE SOMMERSE 10"
10'SUBMERSIBLE BOREHOLE PUMPS
POMPES IMMERGÉES 10"
HYDRAULIKY 10"

50 Hz - n ≈ 2900 rpm

H (m)

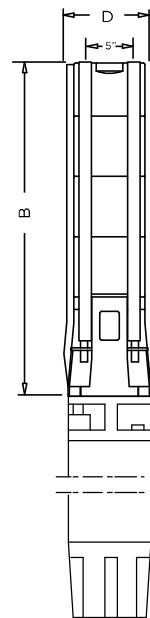
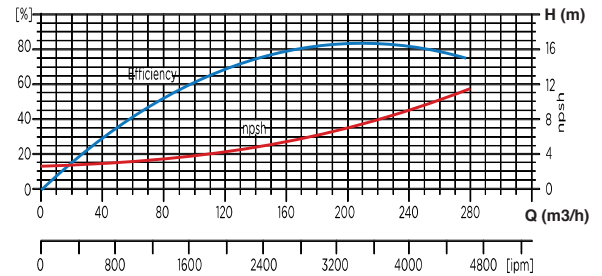
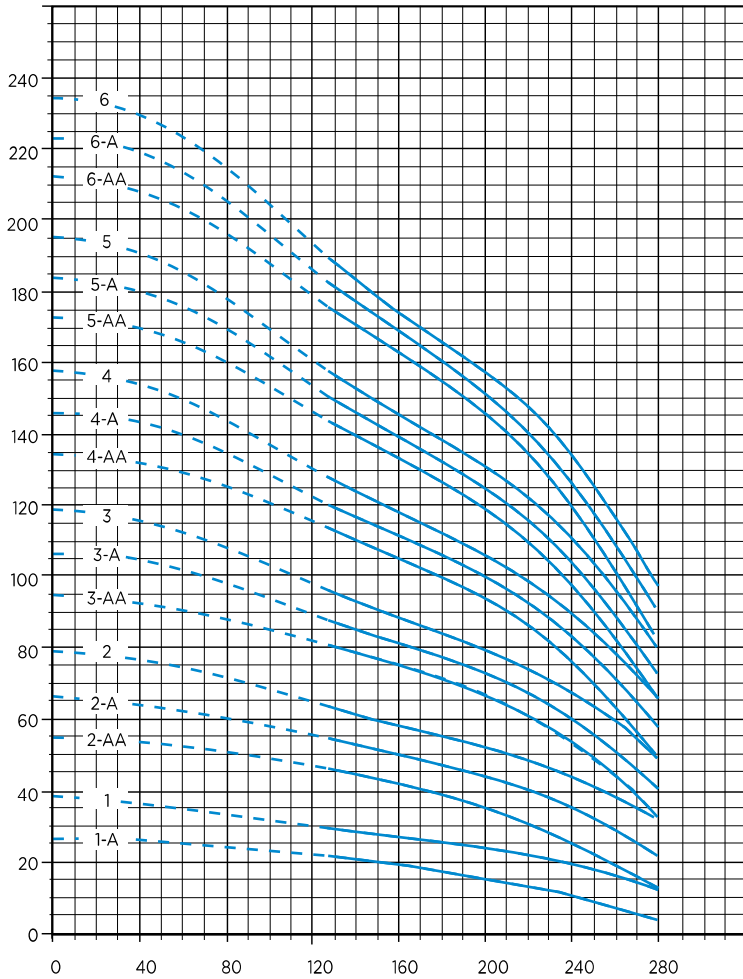

Q (m³/h)

TIPO TYPE	MOTORE MOTOR MOTEUR		Q m³/h l/min	PORTATA - DELIVERY - DEBIT - PRŮTOK														
	KW	HP		0	80	100	120	150	180	200	210	220	230	240	250	260	270	280
SX10 280/1A	15	20	VÝTLAK (m) total head (m)	27	25	24	22	20	17	15	14	12	11	9	7	5	3	2
SX10 280/1	18,5	25		38	33	32	30	27	25	24	23	22	21	18	17	14	11	9
SX10 280/2AA	30	40		55	52	49	47	43	39	36	33	30	28	24	20	16	13	10
SX10 280/2A	37	50		66	61	58	56	51	47	45	42	39	38	34	31	26	21	17
SX10 280/2	45	60		79	72	68	64	59	55	52	50	48	46	43	40	35	32	18
SX10 280/3AA	55	75		95	88	86	83	76	71	65	63	59	57	52	47	40	34	26
SX10 280/3A	55	75		107	98	94	89	83	77	73	70	66	63	58	54	47	41	35
SX10 280/3	67	90		119	108	103	98	90	84	79	77	73	71	66	61	56	50	44
SX10 280/4AA	75	100		135	125	120	115	107	99	94	89	84	80	74	68	60	52	43
SX10 280/4A	75	100		146	135	128	122	113	105	100	95	91	87	81	75	67	59	51
SX10 280/4	75	100		158	144	137	129	119	111	106	102	97	93	87	81	74	67	60
SX10 280/5AA	93	125		173	160	153	146	135	125	118	113	108	102	94	87	77	67	57
SX10 280/5A	93	125		184	169	161	153	141	131	124	119	113	108	101	93	84	75	65
SX10 280/5	93	125		195	178	169	160	148	137	130	125	119	114	107	100	91	82	74
SX10 280/6AA	110	150		212	196	187	178	166	153	144	139	132	126	117	108	96	85	73
SX10 280/6A	110	150		223	205	196	186	172	159	151	145	138	132	123	114	103	93	81
SX10 280/6	110	150		234	214	203	193	178	165	157	151	144	138	129	121	111	100	90

B (mm)	hmotnost
608	28 kg
608	28 kg
784	56 kg
784	56 kg
784	56 kg
960	84 kg
960	84 kg
960	84 kg
1136	110 kg
1136	110 kg
1136	110 kg
1312	139 kg
1312	139 kg
1488	167 kg
1488	167 kg
1488	167 kg

P₂ Potenza nominale motore
 Rated motor power output
 Puissance nominale du moteur
 Jmenovitý výkon motoru.

H Prevalenza totale in m
 Total head in m
 Hauteur totale en m
 Výtlak v m

Tolleranze secondo ISO 9906, allegato A.
 Tolerances according to ISO 9906, annex A.
 Tolérances selon ISO 9906, annexe A.
 Tolerance dle ISO 9906, příloha A.

Con riserva di modifiche
 Changes reserved
 Sous réserves de modifications
 Změny vyhrazeny

SX10 280

POMPE SOMMERSE 10"
10'SUBMERSIBLE BOREHOLE PUMPS
POMPES IMMERGÉES 10"
HYDRAULIKY 10"

50 Hz - n ≈ 2900 rpm

H (m)

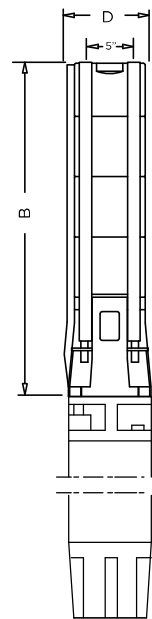
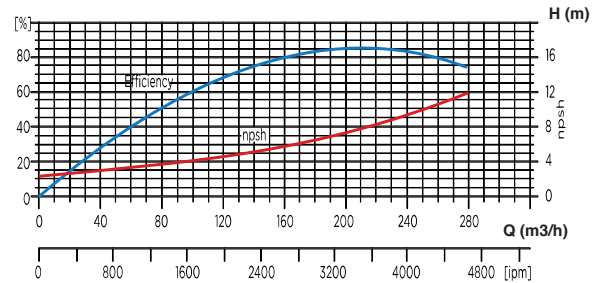
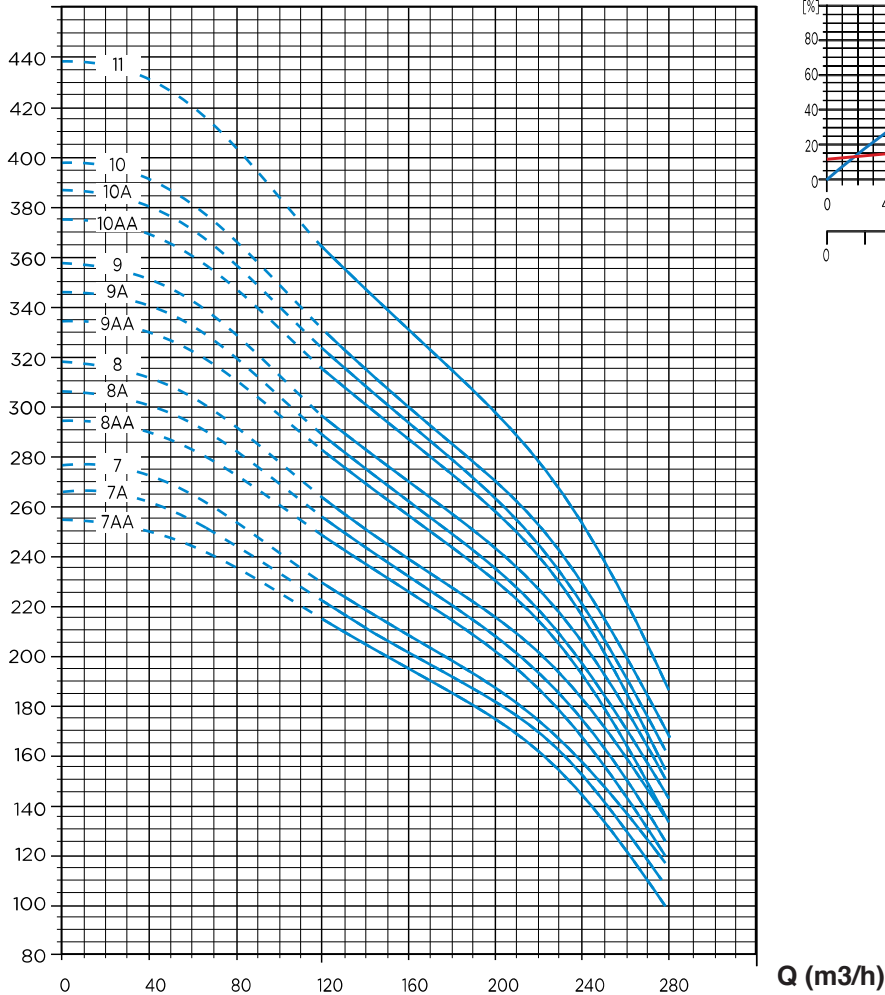

TIPO TYPE TYPE	MOTORE MOTOR MOTEUR		Q m³/h l/min	PORTATA - DELIVERY - DEBIT - PRŮTOK															
	KW	HP		0	80	100	120	150	180	200	210	220	230	240	250	260	270	280	
SX10 280/7AA	130	174	VÝTLAK (m) total head (m)	254	235	225	214	199	185	175	168	160	153	143	133	120	107	94	
SX10 280/7A	130	174		265	245	238	222	205	191	181	174	166	159	150	140	127	115	102	
SX10 280/7	130	174		277	255	241	228	212	197	187	180	173	166	156	146	135	123	112	
SX10 280/8AA	150	200		295	273	261	248	231	214	203	195	187	179	167	156	142	127	113	
SX10 280/8A	150	200		306	283	269	256	237	221	210	202	193	185	174	163	149	135	121	
SX10 280/8	150	200		318	292	278	263	244	227	216	208	199	192	181	170	157	143	129	
SX10 280/9AA	185	250		334	310	296	282	262	243	231	222	212	203	190	177	162	146	130	
SX10 280/9A	185	250		346	319	304	288	268	249	236	228	218	209	197	184	169	154	139	
SX10 280/9	185	250		358	329	312	297	275	255	243	234	225	216	204	191	177	162	147	
SX10 280/10AA	185	250		375	347	332	315	293	272	257	249	238	228	214	200	183	166	148	
SX10 280/10A	185	250		386	356	339	323	300	279	265	255	244	234	221	207	190	173	155	
SX10 280/10	185	250		398	366	347	331	306	285	271	261	251	241	227	214	198	181	165	
SX10 280/11	220	300		438	403	385	364	337	313	297	287	278	266	251	236	219	200	182	

B (mm)	hmotnost
1664	195 kg
1664	195 kg
1664	195 kg
1840	223 kg
1840	223 kg
1840	223 kg
2016	251 kg
2016	251 kg
2016	251 kg
2192	278 kg
2192	278 kg
2192	278 kg
2368	306 kg

P₂ Potenza nominale motore
 Rated motor power output
 Puissance nominale du moteur
 Jmenovitý výkon motoru.

H Prevalenza totale in m
 Total head in m
 Hauteur totale en m
 Výtlak v m

Tolleranze secondo ISO 9906, allegato A.
 Tolerances according to ISO 9906, annex A.
 Tolérances selon ISO 9906, annexe A.
 Tolerance dle ISO 9906, příloha A.

Con riserva di modifiche
 Changes reserved
 Sous réserves de modifications
 Změny vyhrazeny

SX

POMPE SOMMERSE 4", 6", 8", 10"
4", 6", 8", 10" SUBMERSIBLE BOREHOLE PUMPS
POMPES IMMERGEES 4", 6", 8", 10"
HYDRAULIKY 10"

subteck

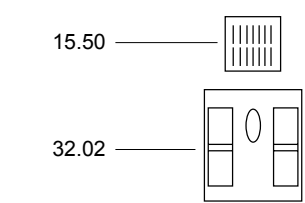
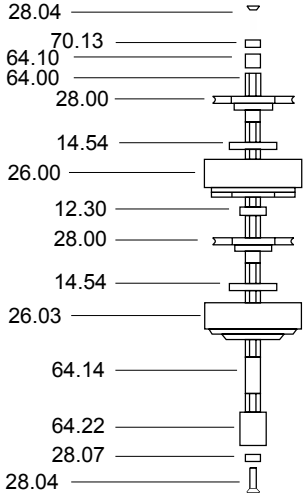
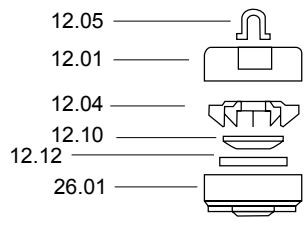
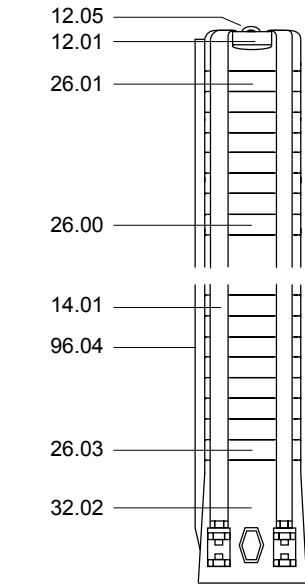

SX4 1,5
SX4 2,8
SX4 4
SX4 5,5
SX4 10

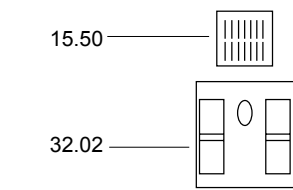
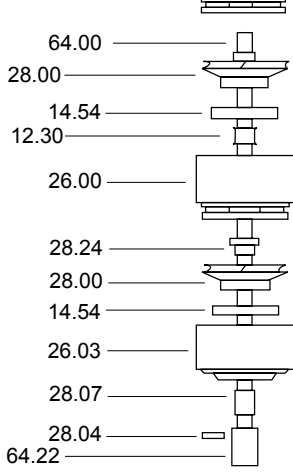
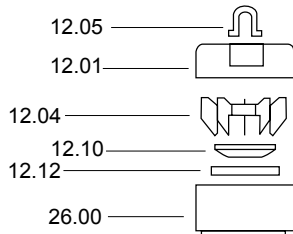
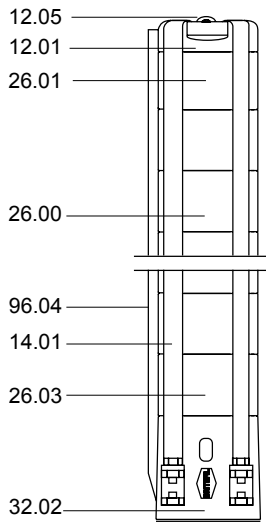

SX4 13

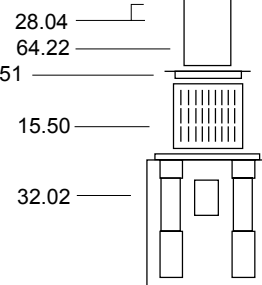
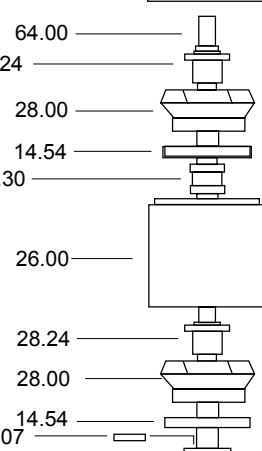
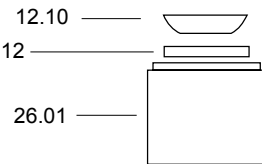
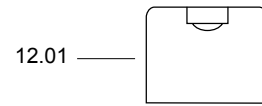
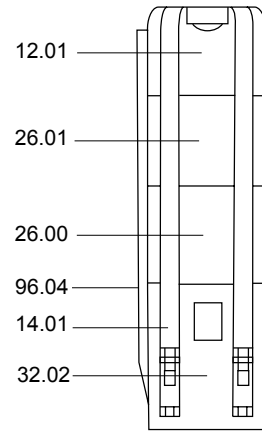

SX6 21
SX6 35
SX6 60
SX6 80
SX8 120
SX8 160
SX8 200
SX10 200
SX10 280

SX

POMPE SOMMERSE 4", 6", 8", 10"
4", 6", 8", 10" SUBMERSIBLE BOREHOLE PUMPS
POMPES IMMERGEES 4", 6", 8", 10"
HYDRAULIKY 8", 10"

subteck

POS	Popis	Materiál
26.00	Difuzor	AISI 304-316
26.03	Dolní difuzor	AISI 304-316
26.01	Vrchní difuzo	AISI 304-316
28.00	Oběžné kolo	AISI 304-316
28.24	Uzamykací pouzdro	AISI 304-316
32.02	Sací hrdlo	AISI 304-316
12.01	Výtlačné hrdlo	AISI 304-316
64.00	Hřídel čerpadla	AISI 304-316
64.22	Spojování	AISI 316
28.07	Dolní podložka	AISI 304-316
28.04	Šroub oběžného kola	AISI 304-316
14.54	Pojistný kroužek	NBR
12.30	Těleso	AISI 304-316
14.01	Spojovací šroub	AISI 304-316
96.04	Kryt kabelů	AISI 304-316
21.10	Sada ventilů	AISI 304-316
12.12	Pojistný ventil	NBR
15.50	Sítka	AISI 304-316
12.05	Pojistný kroužek	AISI 316
70.13	Podložka	AISI 304-316
64.10	Ložiskové pouzdro	AISI 304-316
64.14	Spodní distanční pouzdro	AISI 304-316
15.51	Podložka	AISI 304-316
12.04	Vedení ventilu	AISI 304-316