

SX

POMPE SOMMERSE 4", 6", 8", 10"
 4", 6", 8", 10" SUBMERSIBLE BOREHOLE PUMPS
 POMPES IMMERGEES 4", 6", 8", 10"
 HYDRAULIKY 8", 10"

50 Hz
 n ≈ 2900 rpm

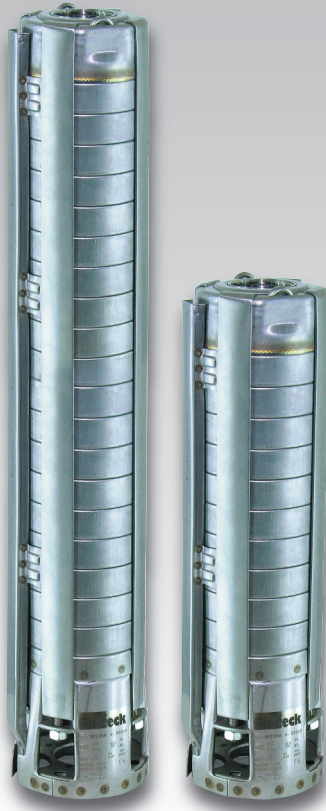

Pompe per applicazioni specifiche ad alto contenuto di sabbia. - Pumps for specific applications with high percentage of solids and sand
 Pompes pour applications spécifiques à haute teneur en solides et sable. - Hydrauliky pro specifické aplikace s vysokým podílem pevných látek a písku

Campo di applicazione - Coverage chart - Graphique d'utilisation - Výkonový graf

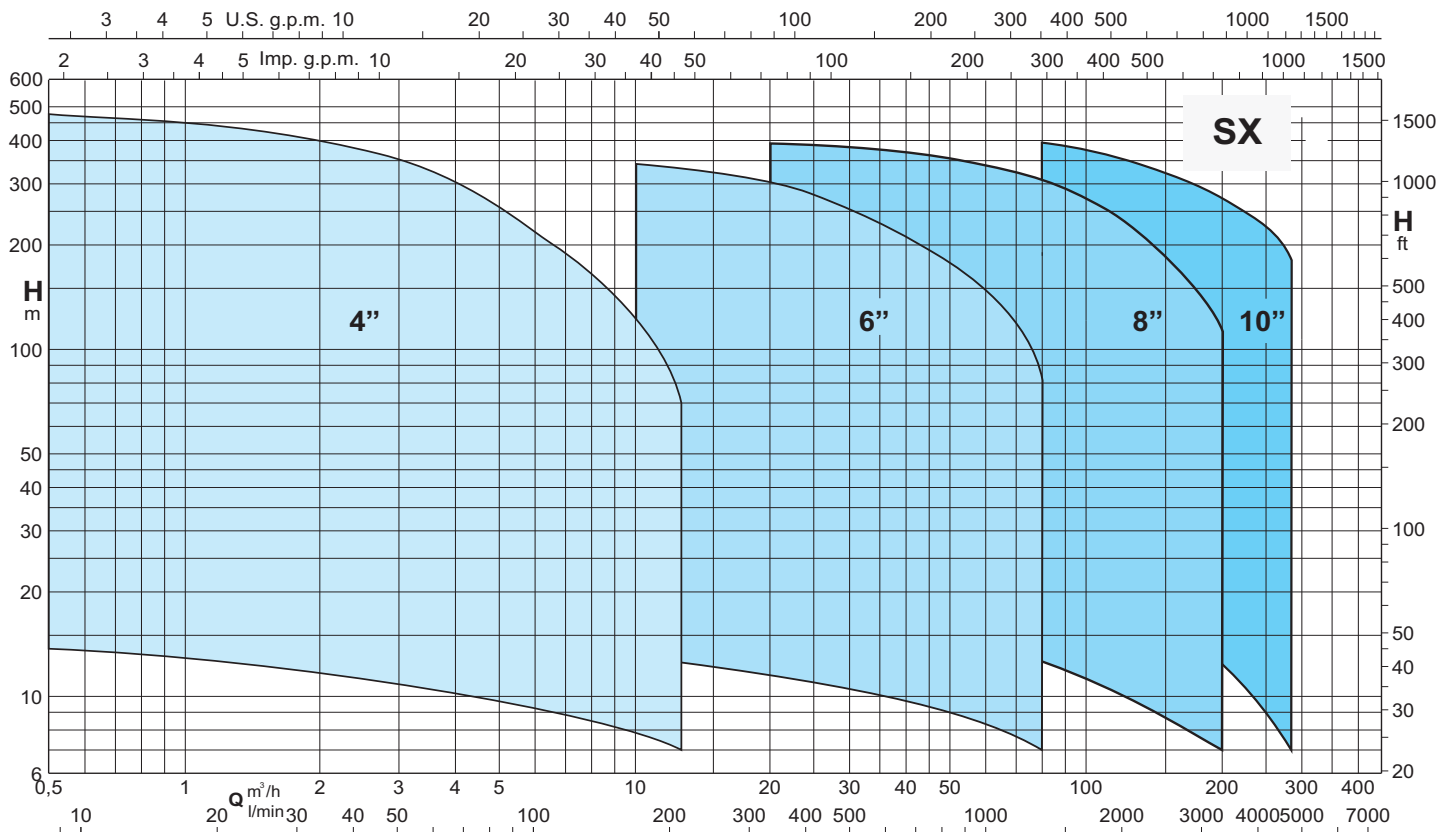

Tolleranze secondo ISO 9906-A - Tolerances according to ISO 9906-A - Tolérances suivant ISO 9906-A - Tolerancias según ISO 9906-A
 Le curve di prestazione sono basate su valori di viscosità cinematica = 1 mm²/s e densità pari a 1000 kg/m³ - Les courbes de performances sont basées sur des valeurs de viscosité cinématique égale à 1 mm²/s et une densité égale à 1000 kg/m³ The performance curves are based on the kinematic viscosity values = 1 mm²/s and density equal to 1000 kg/m³ - Výkonové křivky jsou vztaženy k hodnotám kinematické viskozity = 1 mm² / sa hustotě rovné 1000 kg / m³

SX

POMPE SOMMERSE 4", 6", 8", 10"
4", 6", 8", 10" SUBMERSIBLE BOREHOLE PUMPS
POMPES IMMERGEES 4", 6", 8", 10"
HYDRAULIKY 8", 10"

subteck**Esecuzione**

Elettropompe sommerse di acciaio inossidabile al nichel-cromo per pozzi profondi da 4,6,8,10".

SX: con camicia esterna e stadi in acciaio inossidabile AISI 304.

SX.N: con camicia esterna e stadi in acciaio inossidabile AISI 316.

Giranti: - Radiali: SX4 1,5-2,8-4-5,5-10
 - Semiassiali: SX4 13-20, SX6- SX8 - SX10

Bocca: Filettata ISO 228

Valvola di ritegno incorporata nel corpo di mandata.

Impieghi

Per l'approvvigionamento d'acqua. Per applicazioni civili e industriali.
 Per impianti antincendio. Per irrigazione.

Limiti d'impiego

Temperatura acqua fino a 30 °C.

Massima quantità di sabbia nell'acqua: 300 g/m³.

Servizio continuo.

Materiali

Componenti	SX	SX/N
Camicia esterna	Acciaio Cr Ni AISI 304	Acciaio Cr Ni Mo AISI 316L
Lanterna aspirante		
Coperchio superiore	Acciaio Cr Ni	Acciaio Cr Ni Mo
Corpo di mandata	AISI 304	AISI 316L
Filtro	Acciaio Cr Ni	Acciaio Cr Ni Mo
Valvola completa	AISI 304	AISI 316L
O-ring valvola	NBR	
Giunto completo	Acciaio Cr Ni Mo AISI 316	
Diffusore	Acciaio Cr Ni AISI 304	Acciaio Cr Ni Mo AISI 316L
Corpo stadio		
Girante	Acciaio Cr Ni	Acciaio Cr Ni Mo
Albero	AISI 304	AISI 316L
Anello di tenuta	NBR	
Cuscinetto di guida	NBR	
Copricavo, Viteria	Acciaio Cr Ni Mo AISI 316	

Esecuzioni speciali a richiesta

- Altre tensioni. - Frequenza 60 Hz.

**Exécution**

Electropompes immergées en acier inoxydable au chrome-nickel pour puits de 4,6,8,10".

SX: avec chemise extérieure et étages en acier inox AISI 304

SX N: avec chemise extérieure et étages en acier inox AISI 316.

Roues: - Roues radiales: SX4 1,5-2,8-4-5,5-10
 - Roues hélicocentrifuges: SX4 13-20, SX6- SX8 - SX10

Orifice: Orifice fileté ISO 228

Clapet de retenue incorporé dans le corps de refoulement.

Utilisations

Pour eau propres, non agressifs. Pour l'approvisionnement en eau.
 Pour irrigation. Pour applications civiles, industrielles et pour services incendie.

Limites d'utilisations

Température de l'eau jusqu'à 30 °C.

Max quantité de sable dans l'eau: 300 g/m³.

Service continu.

Matériaux

Composants	SX	SX/N
Chemise extérieure	Acier Cr-Ni AISI 304	Acier Cr-Ni-Mo AISI 316L
Lanterne d'aspiration		
Couvercle supérieur	Acier Cr-Ni	Acier Cr-Ni-Mo
Corps de refoulement	AISI 304	AISI 316L
Panier,	Acier Cr-Ni	Acier Cr-Ni-Mo
Clapet, ensemble	AISI 304	AISI 316L
Joint de clapet	NBR	
Accouplement	Acier Cr-Ni-Mo AISI 316	
Diffuseur	Acier Cr-Ni AISI 304	Acier Cr-Ni-Mo AISI 316L
Corps d'étage		
Roue	Acier Cr-Ni	Acier Cr-Ni-Mo
Arbre	AISI 304	AISI 316L
Bague d'étanchéité	NBR	
Coussinet	NBR	
Protège-câble, Vis	Acier Cr-Ni-Mo AISI 316	

Exécutions spéciales sur demande

- Autres tensions. - Fréquence 60 Hz.

Construction

Submersible motor pumps in chrome-nickel stainless steel for deep wells of 4,6,8,10".

SX: with external jacket and stages in stainless steel AISI 304.

SX N: with external jacket and stages in stainless steel AISI 316.

Impellers: - Radial impellers: SX4 1,5-2,8-4-5,5-10
 - Mixed flow impellers: SX4 13-20, SX6- SX8 - SX10

Connection: Screwed connection ISO 228

Delivery casing with built-in non-return valve.

Applications

For clean water, non-aggressive. For water supply. For irrigation.
 For civil and industrial applications. For fire fighting applications.

Operating conditions

Liquid temperature up to a 30 °C.

Max. sand quantity into the water: 300 g/m³.

Continuous duty.

Materials

Components	SX	SX/N
External jacket	Cr-Ni steel	Cr-Ni-Mo steel
Suction lantern	AISI 304	AISI 316L
Upper cover	Cr-Ni steel	Cr-Ni-Mo steel
Delivery casing	AISI 304	AISI 316L
Strainer	Cr-Ni steel	Cr-Ni-Mo steel
Valve set	AISI 304	AISI 316L
O-ring valve	NBR	
Coupling set	Cr-Ni-Mo steel AISI 316	
Diffuser	Cr-Ni steel	Cr-Ni-Mo steel
Stage casing	AISI 304	AISI 316L
Impeller	Cr-Ni steel	Cr-Ni-Mo steel
Shaft	AISI 304	AISI 316L
Wear ring	NBR	
Bearing bush	NBR	
Cable guard, Screws	Cr-Ni-Mo steel AISI 316	

Speciální vlastnosti na vyžádání

- Jiné napětí - 60 Hz frekvence.

**Konstrukce**

Hydrauliky z chromniklové nerezové oceli pro hluboké vrty 4,6,8,10".

SX: s vnějším pláštěm a články z nerezové oceli AISI 304.

SX N: s vnějším pláštěm a články z nerezové oceli AISI 316.

Oběžná kola: - Radiální: SX4 1,5-2,8-4-5,5-10
 - Smíšené: SX4 13-20, SX6- SX8 - SX10

Connection: Screwed connection ISO 228

Delivery casing with built-in non-return valve.

Apikace

Připojení: Šroubové připojení ISO 228

Zabudovaný zpětný ventil.

Pracovní podmínky

Teplota kapaliny do 30 °C.

Max. množství písku do vody: 300 g / m³.

Nepřetržitý provoz.

Materiály

Součásti	SX	SX/N
Vnější plášť	Cr-Ni ocel	Cr-Ni-Mo ocel
Sací hrdlo	AISI 304	AISI 316L
Horní kryt	Cr-Ni ocel	Cr-Ni-Mo ocel
Výtláčné hrdlo	AISI 304	AISI 316L
Šítko	Cr-Ni ocel	Cr-Ni-Mo ocel
Sada ventilů	AISI 304	AISI 316L
Kroužek ventilu	NBR	
Spojovací sada	Cr-Ni-Mo ocel AISI 316	
Difuzor	Cr-Ni ocel	Cr-Ni-Mo ocel
Těleso hydrauliky	AISI 304	AISI 316L
Oběžné kolo	Cr-Ni ocel	Cr-Ni-Mo ocel
Hřídel	AISI 304	AISI 316L
Pojistný kroužek	NBR	
Ložiskové pouzdro	NBR	
Kryt kabelu, šrouby	Cr-Ni-Mo ocel AISI 316	

Speciální vlastnosti na vyžádání

- Jiné napětí - frekvence 60 Hz.

SX8 120

POMPE SOMMERSE 8"
8" SUBMERSIBLE BOREHOLE PUMPS
POMPES IMMERGÉES 8"
HYDRAULIKY 8"

50 Hz - n ≈ 2900 rpm

H (m)

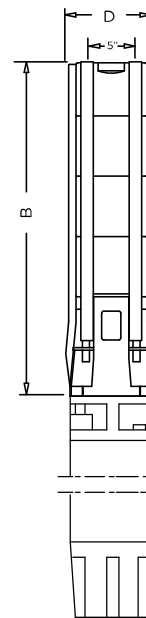
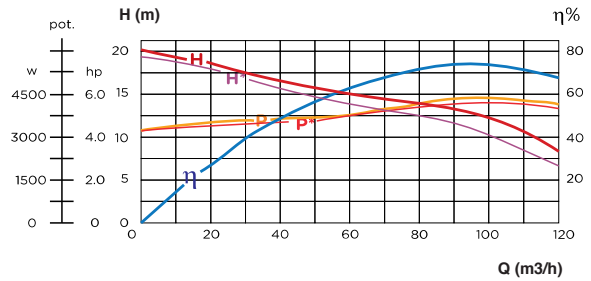
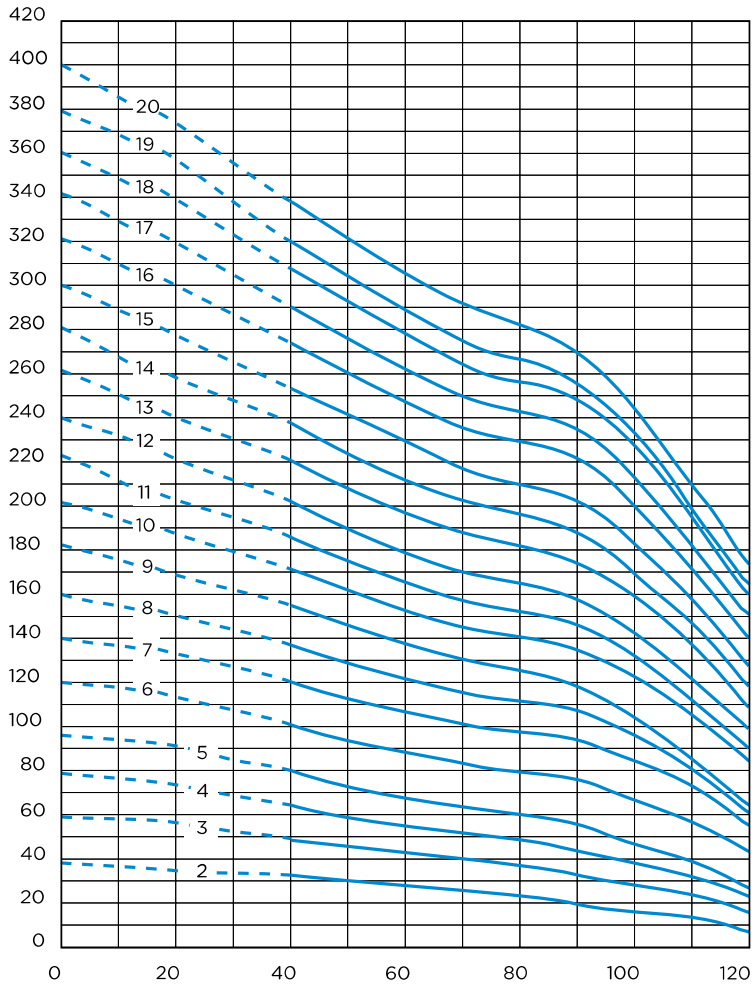

TIPO TYPE TYPE	MOTORE MOTOR MOTEUR		Q m³/h l/min	PORTATA - DELIVERY - DEBIT - PRŮTOK													
	KW	KP		0	10	20	30	40	50	60	70	80	90	100	110	120	
SX8 120/2	9,3	12,5	VÝTLAK (m) total head (m)	39	38	36	34	31	29	27	29	24	22	19	15	11	
SX8 120/3	15	20		59	57	54	58	48	45	42	40	38	35	30	25	19	
SX8 120/4	18,5	25		77	75	71	67	63	59	55	52	50	46	41	34	26	
SX8 120/5	22	30		96	93	89	83	78	73	68	65	62	57	50	41	30	
SX8 120/6	30	40		119	116	111	104	98	93	88	84	81	77	69	59	46	
SX8 120/7	37	50		140	137	132	124	118	112	107	102	99	95	86	75	61	
SX8 120/8	37	50		160	156	150	142	134	128	122	116	112	108	98	85	70	
SX8 120/9	45	60		181	177	170	160	151	144	137	131	126	121	111	96	78	
SX8 120/10	45	60		201	195	188	178	168	160	152	145	141	135	123	106	87	
SX8 120/11	52	70		221	213	204	193	182	173	165	157	152	146	133	114	93	
SX8 120/12	55	75		240	232	222	209	198	188	178	170	165	158	143	123	102	
SX8 120/13	60	80		261	252	242	229	216	206	196	187	181	174	159	137	111	
SX8 120/14	67	90		281	272	261	246	233	221	210	201	195	186	170	147	120	
SX8 120/15	67	90		299	290	279	263	249	236	225	215	208	200	182	158	130	
SX8 120/16	75	100		321	313	301	284	269	257	245	234	226	219	201	174	143	
SX8 120/17	83	111		341	331	319	302	285	272	260	248	240	232	213	184	152	
SX8 120/18	83	111		360	350	337	319	302	288	275	262	255	246	226	196	162	
SX8 120/19	93	125		379	368	353	333	315	300	280	273	264	254	233	201	165	
SX8 120/20	93	125		400	387	372	352	332	317	302	288	280	268	245	212	174	

B (mm)	hmotnost
584	16,7 kg
719	20,2 kg
854	23,7 kg
989	27,2 kg
1159	32,7 kg
1294	36,2 kg
1429	39,7 kg
1564	43,2 kg
1699	46,7 kg
1834	50,2 kg
1969	53,7 kg
2104	57,2 kg
2239	60,7 kg
2374	66 kg
2509	69,6 kg
2644	73,2 kg
2779	76,8 kg
2914	80,4 kg
3049	84 kg

P₂ Potenza nominale motore
 Rated motor power output
 Puissance nominale du moteur
 Jmenovitý výkon motoru.

H Prevalenza totale in m
 Total head in m
 Hauteur totale en m
 Výtlak v m

Tolleranze secondo ISO 9906, allegato A.
 Tolerances according to ISO 9906, annex A.
 Tolérances selon ISO 9906, annexe A.
 Tolerance dle ISO 9906, příloha A.

Con riserva di modifiche
 Changes reserved
 Sous réserves de modifications
 Změny vyhrazeny

SX8 160

POMPE SOMMERSE 8"
8" SUBMERSIBLE BOREHOLE PUMPS
POMPES IMMERGÉES 8"
HYDRAULIKY 8"

50 Hz - n ≈ 2900 rpm

H (m)

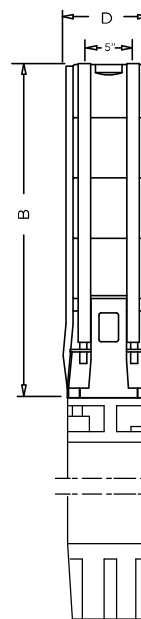
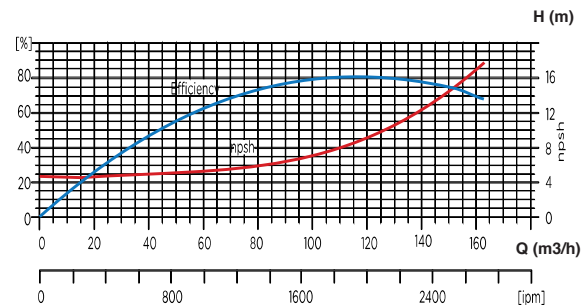
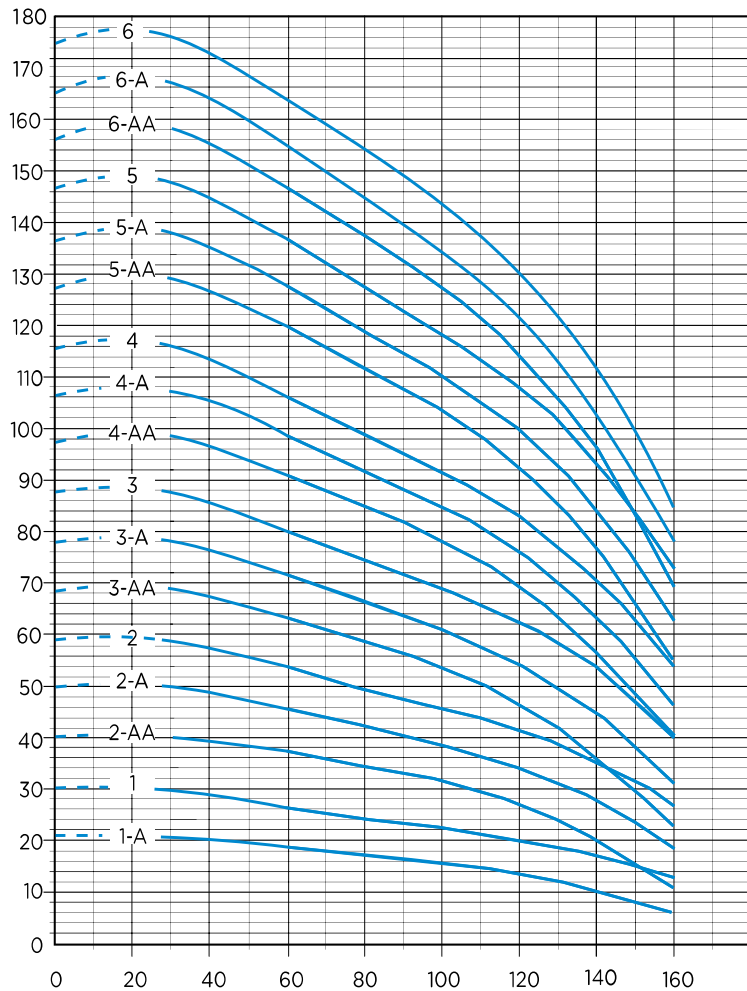

TIPO TYPE	MOTORE MOTOR		Q m³/h l/min	PORTATA - DELIVERY - DEBIT - PRŮTOK															
	KW	HP		0	30	40	50	60	70	80	90	100	110	120	130	140	150	160	
SX8 160/1A	7,5	10	21	22	21	20	19	18	16	15	14	13	12	10	8	6	4		
SX8 160/1	11	15	30	30	29	28	27	25	23	23	20	19	18	17	15	13	11		
SX8 160/2AA	15	20	40	41	40	39	38	36	34	31	29	27	25	22	18	14	9		
SX8 160/2A	18,5	25	50	50	49	48	46	44	41	37	37	35	32	29	26	21	17		
SX8 160/2	22	30	59	59	58	56	55	52	49	46	44	42	40	37	33	30	25		
SX8 160/3AA	22	30	69	69	67	65	64	61	58	54	52	48	45	40	34	28	20		
SX8 160/3A	30	40	78	78	77	75	73	69	66	62	59	56	52	48	43	36	29		
SX8 160/3	30	40	88	88	86	83	81	77	73	70	67	64	60	56	51	45	38		
SX8 160/4AA	37	50	98	99	97	94	92	88	84	80	76	72	67	61	54	46	36		
SX8 160/4A	37	50	107	107	105	102	100	95	91	86	83	79	74	68	61	53	44		
SX8 160/4	37	50	116	116	114	110	107	102	98	93	79	85	81	75	69	61	52		
SX8 160/5AA	45	60	127	129	127	123	121	116	111	106	101	96	91	83	75	64	52		
SX8 160/5A	45	60	136	138	135	132	128	123	118	113	108	103	98	91	82	72	61		
SX8 160/5	55	75	146	148	145	141	138	132	126	121	117	112	106	100	91	82	70		
SX8 160/6AA	55	75	156	158	155	151	148	142	136	130	125	119	112	104	93	81	67		
SX8 160/6A	55	75	165	167	164	160	156	150	143	137	132	126	119	111	101	89	75		
SX8 160/6	67	90	175	177	173	169	165	158	152	145	140	134	128	120	110	98	85		

B (mm)	hmotnost
641,0	27,0 kg
641,0	27,0 kg
797,0	33,0 kg
797,0	33,0 kg
797,0	33,0 kg
953,0	39,0 kg
953,0	39,0 kg
953,0	39,0 kg
1109,0	45,0 kg
1109,0	45,0 kg
1109,0	45,0 kg
1265,0	51,0 kg
1265,0	51,0 kg
1265,0	51,0 kg
1421,0	57,0 kg
1421,0	57,0 kg
1421,0	57,0 kg

P_e Potenza nominale motore
 Rated motor power output
 Puissance nominale du moteur
 Jmenovitý výkon motoru.

H Prevalenza totale in m
 Total head in m
 Hauteur totale en m
 Výtlak v m

Tolleranze secondo ISO 9906, allegato A.
 Tolerances according to ISO 9906, annex A.
 Tolérances selon ISO 9906, annexe A.
 Tolerance dle ISO 9906, příloha A.

Con riserva di modifiche
 Changes reserved
 Sous réserves de modifications
 Změny vyhrazeny

SX8 160

POMPE SOMMERSE 8"
8" SUBMERSIBLE BOREHOLE PUMPS
POMPES IMMERGÉES 8"
HYDRAULIKY 8"

50 Hz - n ≈ 2900 rpm

H (m)

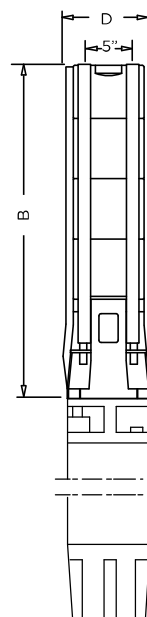
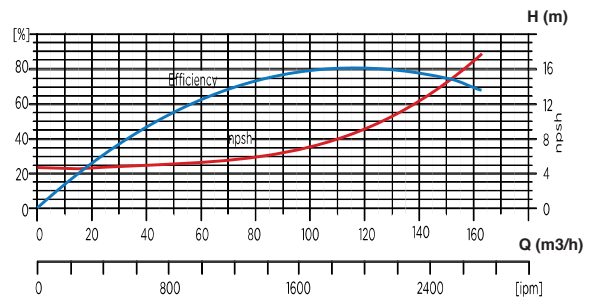
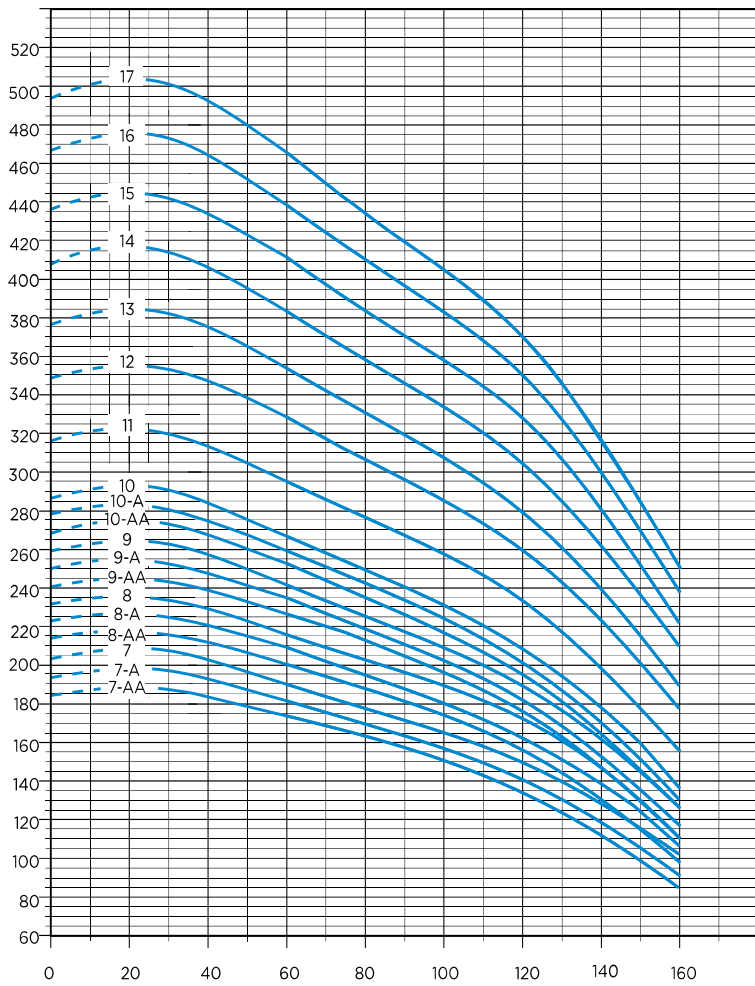

TIPO TYPE TYPE	MOTORE MOTOR MOTEUR		Q m³/h l/min	PORTATA - DELIVERY - DEBIT - PRŮTOK															
	KW	HP		0	30	40	50	60	70	80	90	100	110	120	130	140	150	160	
SX8 160/7AA	67	90	VÝTLAK (m) total head (m)	185	186	183	180	175	168	162	155	149	142	134	124	112	98	81	
SX8 160/7A	67	90		194	196	192	187	183	176	169	162	156	149	141	131	120	105	90	
SX8 160/7	75	100		204	207	202	196	192	184	177	170	163	157	149	140	128	115	99	
SX8 160/8AA	75	100		214	217	212	207	202	194	187	179	172	164	155	144	130	114	95	
SX8 160/8A	75	100		223	227	220	215	210	202	194	186	179	171	162	151	137	121	103	
SX8 160/8	75	100		232	237	230	223	217	209	201	193	186	178	169	158	145	129	111	
SX8 160/9AA	93	125		241	246	240	232	228	219	211	202	194	185	175	162	147	128	108	
SX8 160/9A	93	125		250	255	248	242	235	226	218	209	201	192	182	169	154	136	115	
SX8 160/9	93	125		260	264	257	250	243	234	225	216	207	199	189	176	161	144	123	
SX8 160/10AA	93	125		269	272	267	260	253	244	234	225	216	206	194	180	163	142	119	
SX8 160/10A	93	125		278	281	275	267	261	251	241	231	222	212	201	187	170	150	127	
SX8 160/10	93	125		287	289	283	275	268	258	248	238	229	219	208	194	177	157	135	
SX8 160/11	110	150		316	320	313	305	295	285	275	266	255	245	232	216	196	176	153	
SX8 160/12	130	175		348	353	348	338	328	316	306	295	285	273	260	244	223	200	175	
SX8 160/13	130	175		377	383	376	366	353	342	330	318	312	293	281	262	241	215	186	
SX8 160/14	150	200		407	414	408	396	385	375	358	345	334	321	306	286	262	235	205	
SX8 160/15	150	200		436	443	435	424	417	397	382	370	356	342	327	305	280	250	220	
SX8 160/16	185	252	466	473	465	453	438	424	410	394	381	366	350	326	300	269	235		
SX8 160/17	185	252	495	500	494	480	466	450	433	419	405	388	370	345	317	284	249		

B (mm)	hmotnost
1577,0	63,0 kg
1577,0	63,0 kg
1577,0	63,0 kg
1733,0	70,0 kg
1733,0	70,0 kg
1733,0	70,0 kg
1889	76 kg
1889	76 kg
1889	76 kg
2045	82 kg
2045	82 kg
2045	82 kg
2201	91 kg
2357	97 kg
2513	104 kg
2669	110 kg
2825	116 kg
2981	122 kg
3137	128 kg

P₂ Potenza nominale motore
 Rated motor power output
 Puissance nominale du moteur
 Jmenovitý výkon motoru.

H Prevalenza totale in m
 Total head in m
 Hauteur totale en m
 Výtlak v m

Tolleranze secondo ISO 9906, allegato A.
 Tolerances according to ISO 9906, annex A.
 Tolérances selon ISO 9906, annexe A.
 Tolerance dle ISO 9906, příloha A.

Con riserva di modifiche
 Changes reserved
 Sous réserves de modifications
 Změny vyhrazeny

SX8 200

POMPE SOMMERSE 8"
8" SUBMERSIBLE BOREHOLE
PUMPS POMPES IMMERGÉES 8"
HYDRAULIKY 8"

50 Hz - n ≈ 2900 rpm

H (m)

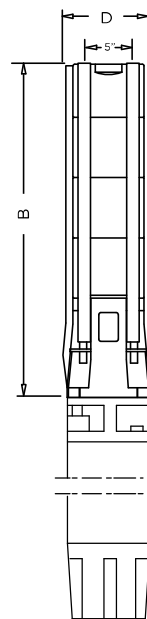
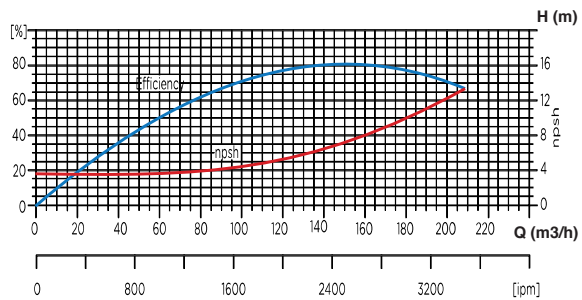
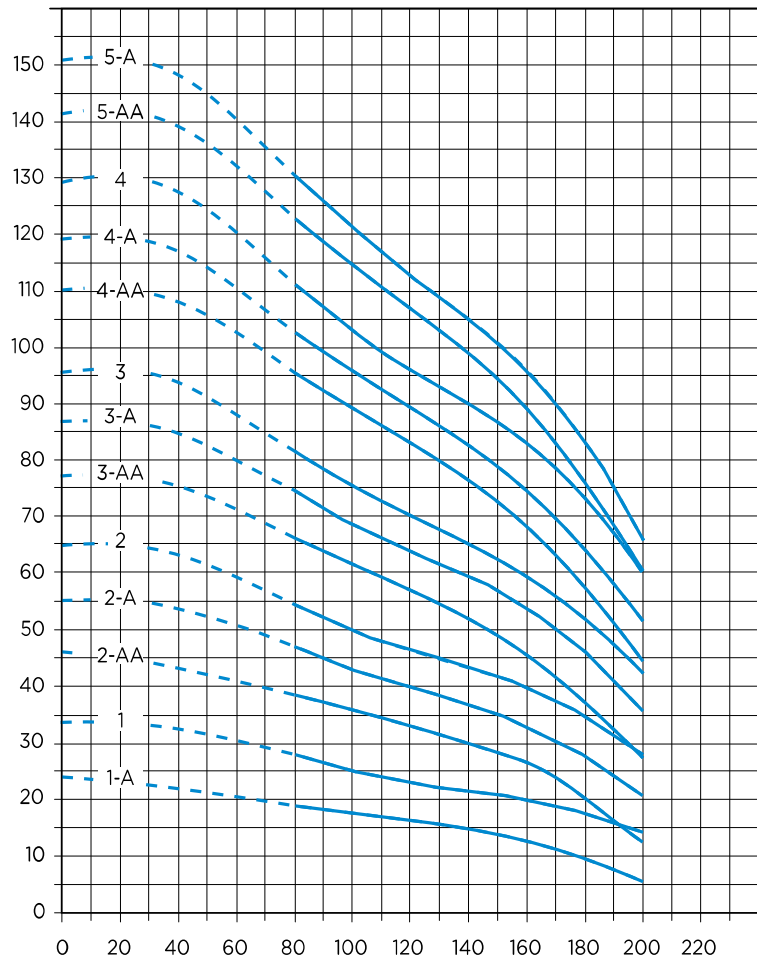

TIPO TYPE	MOTORE MOTOR		Q m³/h l/min	PORTATA - DELIVERY - DEBIT - PRŮTOK															
	KW	HP		0	70	80	90	100	110	120	130	140	150	160	170	180	190	200	
SX8 200/1A	9,3	12,5	VÝTLAK (m) total head (m)	24	20	19	19	18	17	16	15	14	13	12	11	8	6	4	
SX8 200/1	15	20		34	30	29	27	26	24	23	22	21	20	19	19	17	15	13	
SX8 200/2AA	18,5	25		46	40	39	38	37	35	33	32	29	28	25	23	19	15	11	
SX8 200/2A	22	30		55	49	48	46	44	41	40	38	36	34	32	31	27	23	20	
SX8 200/2	30	40		65	57	56	53	51	48	46	45	42	41	39	38	34	31	27	
SX8 200/3AA	30	40		77	69	68	65	63	59	57	55	51	48	45	42	38	32	26	
SX8 200/3A	37	50		87	77	76	73	70	66	64	62	58	56	53	50	45	40	34	
SX8 200/3	37	50		96	85	83	79	76	72	70	68	64	62	59	57	52	47	41	
SX8 200/4AA	45	60		110	99	97	93	90	86	83	80	76	72	68	64	57	51	43	
SX8 200/4A	45	60		119	107	104	100	96	92	89	86	82	79	75	71	64	58	44	
SX8 200/4	55	75		129	115	112	108	104	100	96	93	89	86	82	79	73	66	53	
SX8 200/5AA	55	75		142	128	123	120	115	111	107	103	98	94	89	84	75	67	58	
SX8 200/5A	55	75		151	145	131	127	122	117	113	109	104	100	95	90	82	74	65	

B (mm)	hmotr Øst
641	26 kg
641	26 kg
797	33 kg
797	33 kg
797	33 kg
953	39 kg
953	39 kg
953	39 kg
1109	45 kg
1109	45 kg
1109	45 kg
1265	51 kg
1265	51 kg

P: Potenza nominale motore
 Rated motor power output
 Puissance nominale du moteur
 Jmenovitý výkon motoru.

H: Prevalenza totale in m
 Total head in m
 Hauteur totale en m
 Výtlak v m

Tolleranze secondo ISO 9906, allegato A.
 Tolerances according to ISO 9906, annex A.
 Tolérances selon ISO 9906, annexe A.
 Tolerance dle ISO 9906, příloha A.

Con riserva di modifiche
 Changes reserved
 Sous réserves de modifications
 Změny vyhrazeny

SX8 200

POMPE SOMMERSE 8"
8" SUBMERSIBLE BOREHOLE PUMPS
POMPES IMMERGÉES 8"
HYDRAULIKY 8"

50 Hz - n ≈ 2900 rpm

H (m)

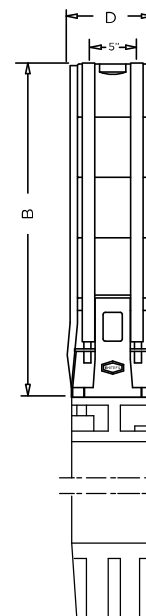
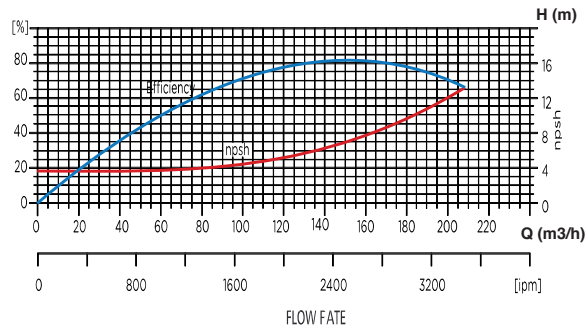
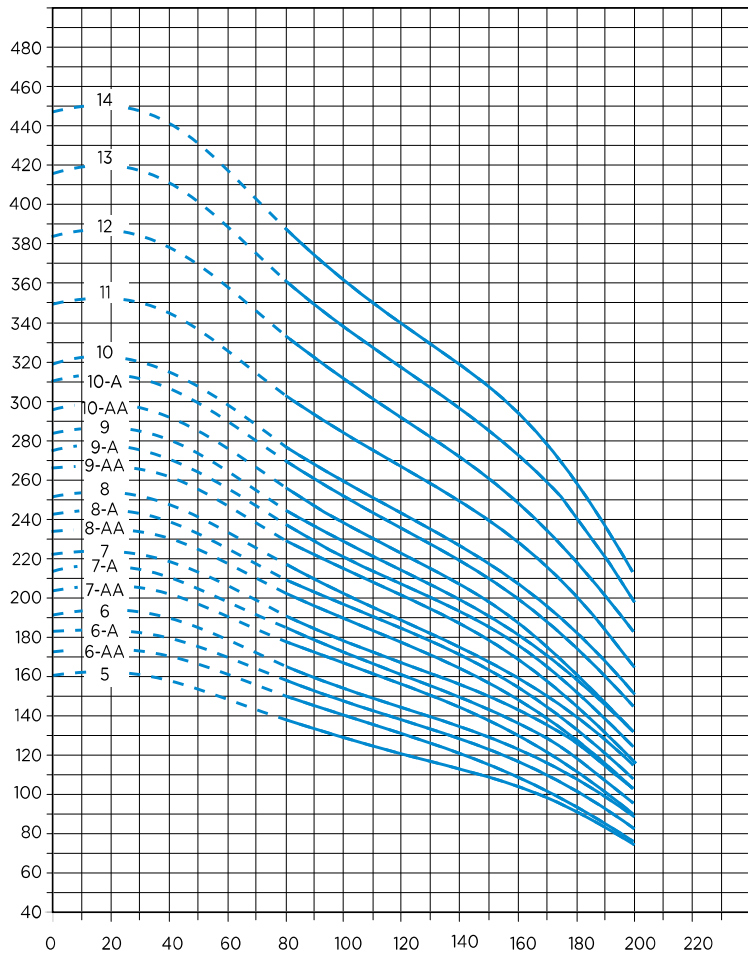

Q (m³/h)

TIPO TYPE TYPE	MOTORE MOTOR MOTEUR		Q m³/h l/min	PORTATA - DELIVERY - DEBIT - PRŮTOK																
	KW	HP		0	70	80	90	100	110	120	130	140	150	160	170	180	190	200		
SX8 200/5	67	90	VÝTLAK (m) total head (m)	161	144	140	134	130	124	120	116	113	108	103	98	90	82	73		
SX8 200/6AA	67	90		173	155	151	146	141	135	131	126	120	115	109	103	93	83	72		
SX8 200/6A	75	100		183	164	159	154	148	142	137	133	127	122	117	111	101	91	80		
SX8 200/6	75	100		192	172	167	160	155	148	144	139	134	129	123	117	108	98	87		
SX8 200/7AA	75	100		204	183	178	172	166	159	154	149	142	136	129	122	111	99	86		
SX8 200/7A	93	125		213	191	185	178	172	165	160	155	148	143	136	128	117	106	93		
SX8 200/7	93	125		222	198	192	185	178	171	166	161	154	149	142	135	124	112	100		
SX8 200/8AA	93	125		234	210	204	196	189	182	176	170	163	156	148	139	126	113	98		
SX8 200/8A	93	125		243	217	211	203	196	188	182	176	169	162	154	145	133	120	105		
SX8 200/8A	93	125		252	225	218	209	202	194	188	182	175	168	160	152	139	126	112		
SX8 200/9AA	110	150		266	239	232	224	216	207	201	194	186	178	169	159	145	130	114		
SX8 200/9A	110	150		275	247	239	230	222	214	207	200	192	185	176	166	152	137	121		
SX8 200/9	110	150		284	254	246	237	228	220	213	206	198	191	182	172	159	144	128		
SX8 200/10AA	110	150		296	265	257	247	237	230	222	215	207	197	188	175	162	144	125		
SX8 200/10A	130	174		310	280	270	260	251	242	235	226	219	212	202	190	175	160	141		
SX8 200/10	130	174		319	287	277	267	257	250	240	232	226	216	209	196	182	166	148		
SX8 200/11	130	174		350	315	303	291	281	272	264	255	246	239	227	215	200	180	162		
SX8 200/12	150	200		383	345	334	320	310	300	290	281	272	263	252	237	220	219	179		
SX8 200/13	185	250		414	375	362	347	335	325	314	305	285	285	274	257	239	235	194		
SX8 200/14	185	250		446	402	387	373	360	349	338	327	316	305	292	275	256	235	208		

B (mm)	hmotnost
1265	51 kg
1421	58 kg
1421	58 kg
1421	58 kg
1577	64 kg
1577	64 kg
1577	64 kg
1733	70 kg
1733	70 kg
1733	70 kg
1889	80 kg
1889	80 kg
1889	80 kg
2045	86 kg
2045	86 kg
2045	86 kg
2201	93 kg
2357	99 kg
2513	105 kg
2669	111 kg

P_e Potenza nominale motore
 Rated motor power output
 Puissance nominale du moteur
 Jmenovitý výkon motoru.

H Prevalenza totale in m
 Total head in m
 Hauteur totale en m
 Výtlak v m

Tolleranze secondo ISO 9906, allegato A.
 Tolerances according to ISO 9906, annex A.
 Tolérances selon ISO 9906, annexe A.
 Tolerance dle ISO 9906, příloha A.

Con riserva di modifiche
 Changes reserved
 Sous réserves de modifications
 Změny vyhrazeny

SX

POMPE SOMMERSE 4", 6", 8", 10"
4", 6", 8", 10" SUBMERSIBLE BOREHOLE PUMPS
POMPES IMMERGEES 4", 6", 8", 10"
HYDRAULIKY 10"

subteck

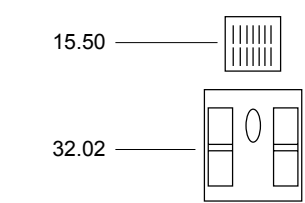
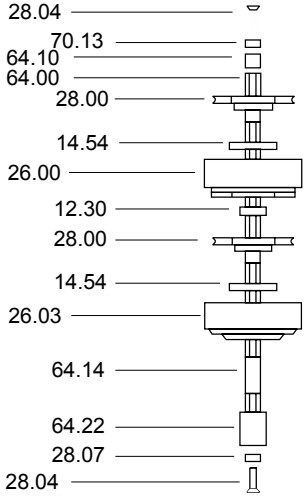
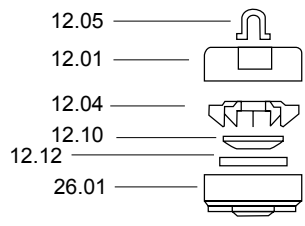
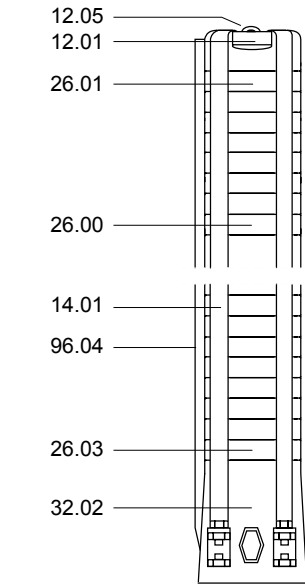

SX4 1,5
SX4 2,8
SX4 4
SX4 5,5
SX4 10

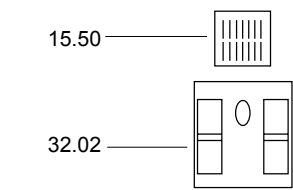
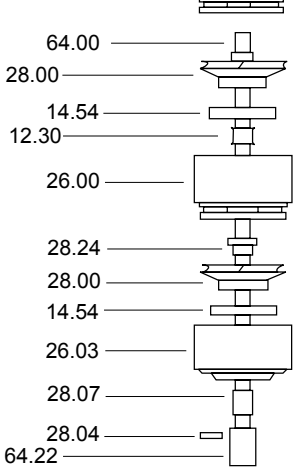
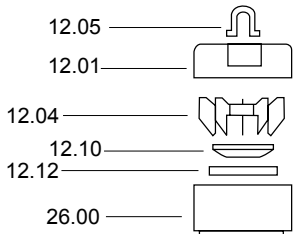
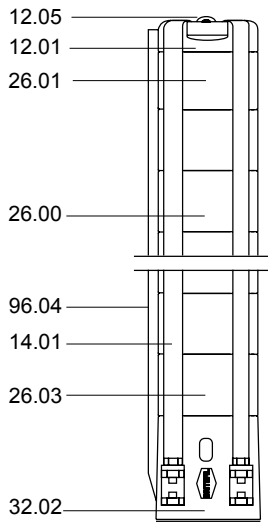

SX4 13

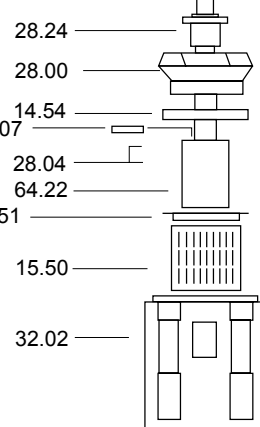
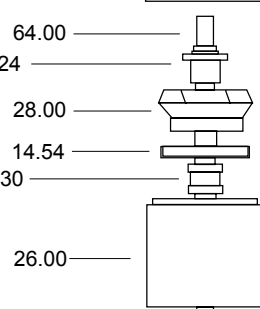
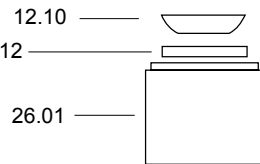
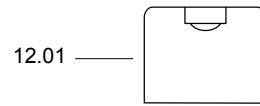
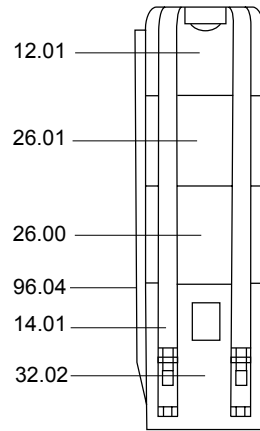

SX6 21
SX6 35
SX6 60
SX6 80
SX8 120
SX8 160
SX8 200
SX10 200
SX10 280

SX

POMPE SOMMERSE 4", 6", 8", 10"
4", 6", 8", 10" SUBMERSIBLE BOREHOLE PUMPS
POMPES IMMERGEES 4", 6", 8", 10"
HYDRAULIKY 8", 10"

subteck

POS	Popis	Materiál
26.00	Difuzor	AISI 304-316
26.03	Dolní difuzor	AISI 304-316
26.01	Vrchní difuzo	AISI 304-316
28.00	Oběžné kolo	AISI 304-316
28.24	Uzamykací pouzdro	AISI 304-316
32.02	Sací hrdlo	AISI 304-316
12.01	Výtlačné hrdlo	AISI 304-316
64.00	Hřídel čerpadla	AISI 304-316
64.22	Spojování	AISI 316
28.07	Dolní podložka	AISI 304-316
28.04	Šroub oběžného kola	AISI 304-316
14.54	Pojistný kroužek	NBR
12.30	Těleso	AISI 304-316
14.01	Spojovací šroub	AISI 304-316
96.04	Kryt kabelů	AISI 304-316
21.10	Sada ventilů	AISI 304-316
12.12	Pojistný ventil	NBR
15.50	Sítka	AISI 304-316
12.05	Pojistný kroužek	AISI 316
70.13	Podložka	AISI 304-316
64.10	Ložiskové pouzdro	AISI 304-316
64.14	Spodní distanční pouzdro	AISI 304-316
15.51	Podložka	AISI 304-316
12.04	Vedení ventilu	AISI 304-316